

REV.	DESCRIPTION	DATE	DRAWN	APPROVED
A1	DWG.REL	2016/10/7	FANG	YANG

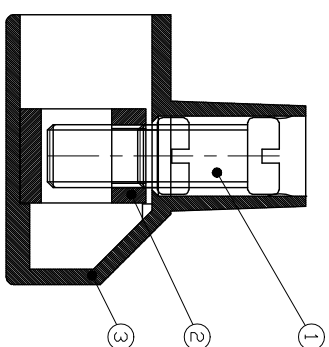
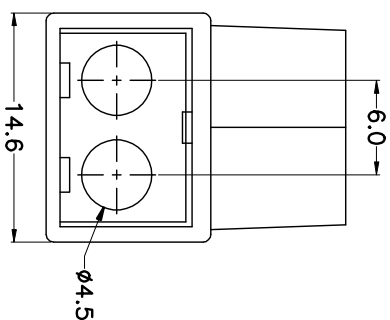
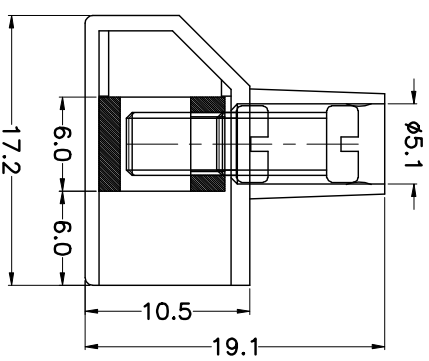
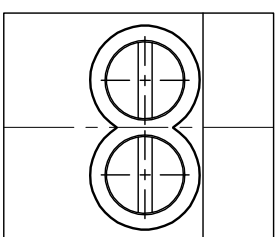

- Material
  - ①Screws : M4.0 steel, Zinc plated,
  - “\_” slot type
  - ②Housing : PC
  - ③Clamp : Brass, Ni plated
  - ④Pin header : Brass, Tin plated

- Electrical IEC
  - Rated voltage : 450V
  - Rated current : 57A

- Mechanical
  - Operating temperature:  $-40^{\circ}\text{C}$  to  $+105^{\circ}\text{C}$
  - Soldering temperature:  $250^{\circ}\text{C} \pm 5/5\text{sec}$
  - Torque: 1.2N.m (10.53Lb.in)
  - Strip length: 10mm

HOW TO ORDER

RU10-T85-6.0-XXP-1 X-XXXXXX

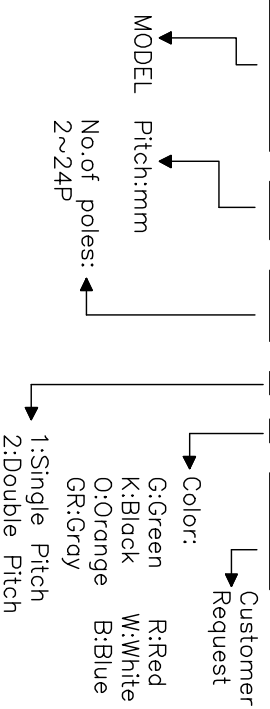

GENERAL TOLERANCE		ANGLE TOLERANCE		PROJECTION		TITLE	
X.	±0.5	X.	±5'	UNITS	mm	RU10-T85-6.0-2P	
.X	±0.3	.X.	±3'	SHEET SIZE	A4	SERIES	RU10-T85
.XX	±0.1	.XX.	±1'	DRAWING TYPE	CUSTOMER		
SCALE	1:1	SHEET	1 OF 1	<b>慈溪市凯峰电子有限公司</b> CIXI KAIFENG ELECTRONIC CO.,LTD			
DRAWING NO.	XP0012016-xxxx						